

# LABBEASY

LABBEASY

## Box Cutter Reliefs

20 box cutter reliefs for beginner's cutting practice with a craft knife

LABBEASY

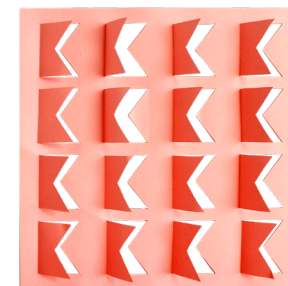
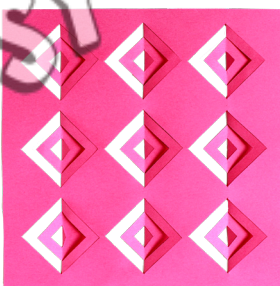
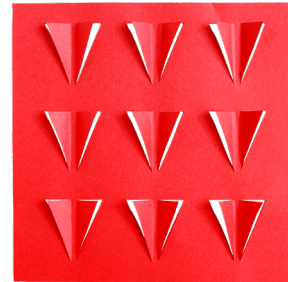
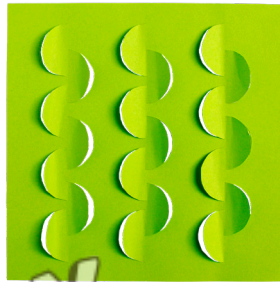
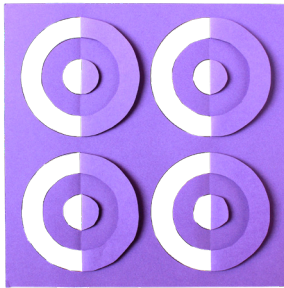

LABBEASY

LABBEASY

PDF 4159-EN

# LABBEASY

LABBEASY

## Box Cutter Reliefs

Introduction & Instructions .....	Page 3
Overview .....	Page 4
Box cutter reliefs .....	Pages 5 - 24

LABBEASY

### PRINT SETTINGS

Please use Acrobat Reader to print and make sure that the settings 'Actual size' and 'Auto portrait/landscape' are selected.

LABBEASY

### SAVE PAPER & TONER

Only print out the pages you need.

### COPYRIGHT & LICENCE

This material is protected by copyright. Labbé holds exclusive rights. © Labbé Publishing

This PDF file may only be used by the original purchaser and is intended for personal use and teaching. Distribution of the PDF file to school staff or to parents and students is not permitted. It is also not permitted to make it available on the internet or to place it on a school server. It is prohibited to use the PDF file, printouts of the PDF file, and objects created from it for commercial purposes. For more information, visit [www.labbeasy.com](http://www.labbeasy.com)

LABBEASY

## INTRODUCTION

# Box Cutter Reliefs

If you cut regular shapes into paper with a box cutter or craft knife, you can then fold the shapes to create a fascinating paper relief that looks three-dimensional due to the effect of light and shadow.

## DON'T BE AFRAID TO USE A CRAFT KNIFE!

If you stick to the following rules when cutting, hardly anything can happen:



The blade should protrude only a few millimeters while working.



Always retract the blade, even if you need to use it again soon.

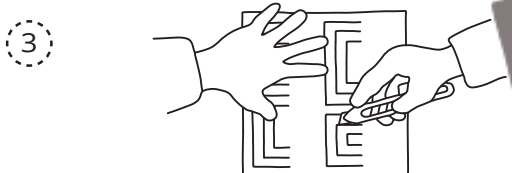

When cutting, do not press the blade too hard and always move it away from your body.

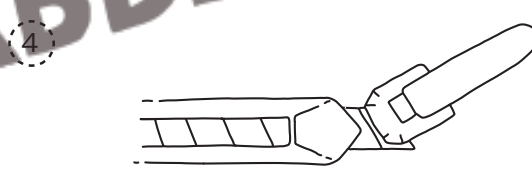

Always use the removable provision at the end of the craft knife or box cutter to break off a blunt blade.

## HOW TO MAKE IT

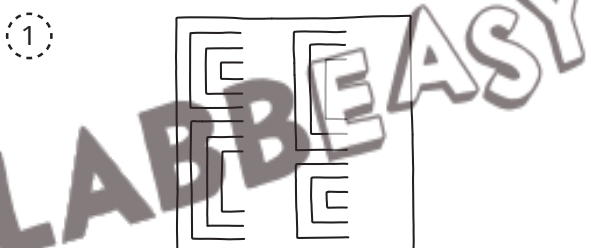

Select a cutting design, print it out and cut out the square along the solid line.

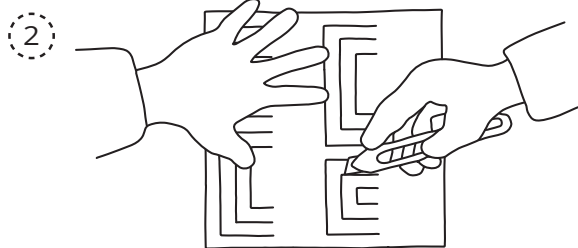

Carefully cut the lines with the box cutter or craft knife. Use cardboard or a cutting mat as a base!

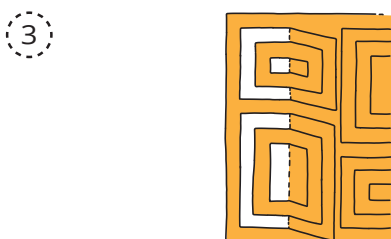

Flip the sheet over and then slightly fold the cut out shapes upward.

### TIP



The box cutter reliefs look especially beautiful when glued on top of different colored paper.

OVERVIEW

# Box Cutter Reliefs



Page 5

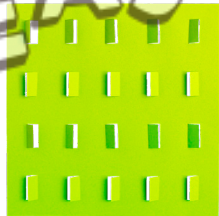

Page 6

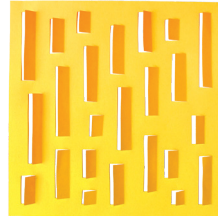

Page 7

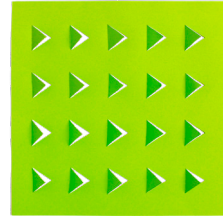

Page 8



Page 9



Page 10



Page 11

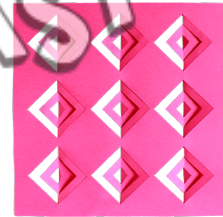

Page 12

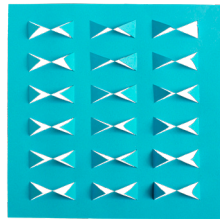

Page 13

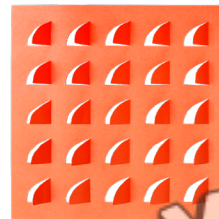

Page 14

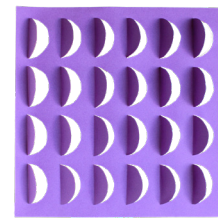

Page 15

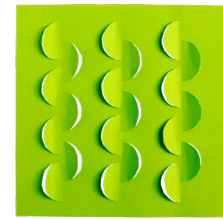

Page 16

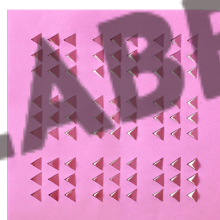

Page 17



Page 18



Page 19

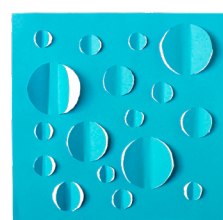

Page 20

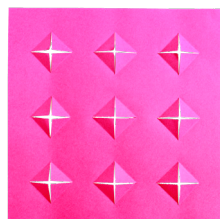

Page 21

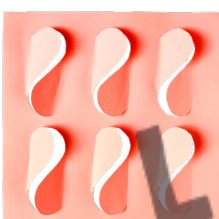

Page 22



Page 23

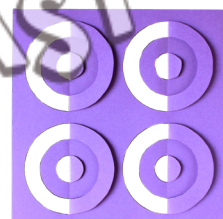

Page 24

## HOW TO MAKE IT

1

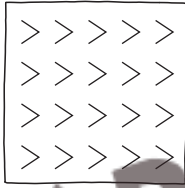

Cut out the square cutting sheet along the solid line.

2



Carefully cut the lines with the craft knife. Use a cutting mat!

3

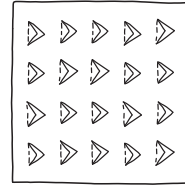

Flip the sheet over and evenly press the cut out shapes upward.

