

LABBEASY

LABBEASY

Large Paper Globe

Craft templates for making a large paper globe,
diameter \varnothing 12,6 inches (32 cm)

LABBEASY

LABBEASY



LABBEASY

PDF 4469-EN

LABBEASY

LABBEASY

Large Paper Globe

How to do it	Page 3
Overview	Page 4
Support elements	Page 5
Globe segments	Pages 6 - 29

PRINT SETTINGS

Please use Acrobat Reader to print and make sure that the settings 'Actual size' and 'Auto portrait/landscape' are selected.

SAVE PAPER & TONER

Only print out the pages you need.

COPYRIGHT & LICENCE

This material is protected by copyright. Labbé holds exclusive rights. © Labbé Publishing

This PDF file may only be used by the original purchaser and is intended for personal use and teaching. Distribution of the PDF file to school staff or to parents and students is not permitted. It is also not permitted to make it available on the internet or to place it on a school server. It is prohibited to use the PDF file, printouts of the PDF file, and objects created from it for commercial purposes. For more information, visit www.labbeasy.com

HOW TO DO IT

Large Paper Globe



Print the templates out on heavy white printing paper and color them in. You can use an atlas as a guide. Carefully cut out all the parts.

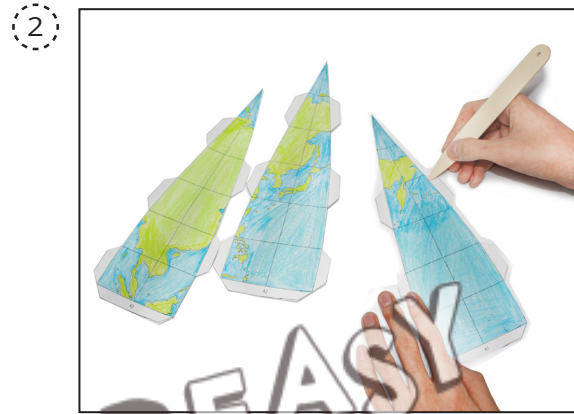

Score the edges of the glueing tabs and fold them back.



Stick the first A segment to the support ring. Continue attaching the following A segments to form a hemisphere. Stick together the other hemisphere using the B segments.



Stick four of the support elements together to form a ring and glue one ring to each hemisphere using the glueing tabs.



Thread a string through the top of the upper hemisphere, A. You'll use this to hang up your finished globe.



Finally, stick the two hemispheres together to form your large globe... AWESOME!!!

OVERVIEW

Large Paper Globe

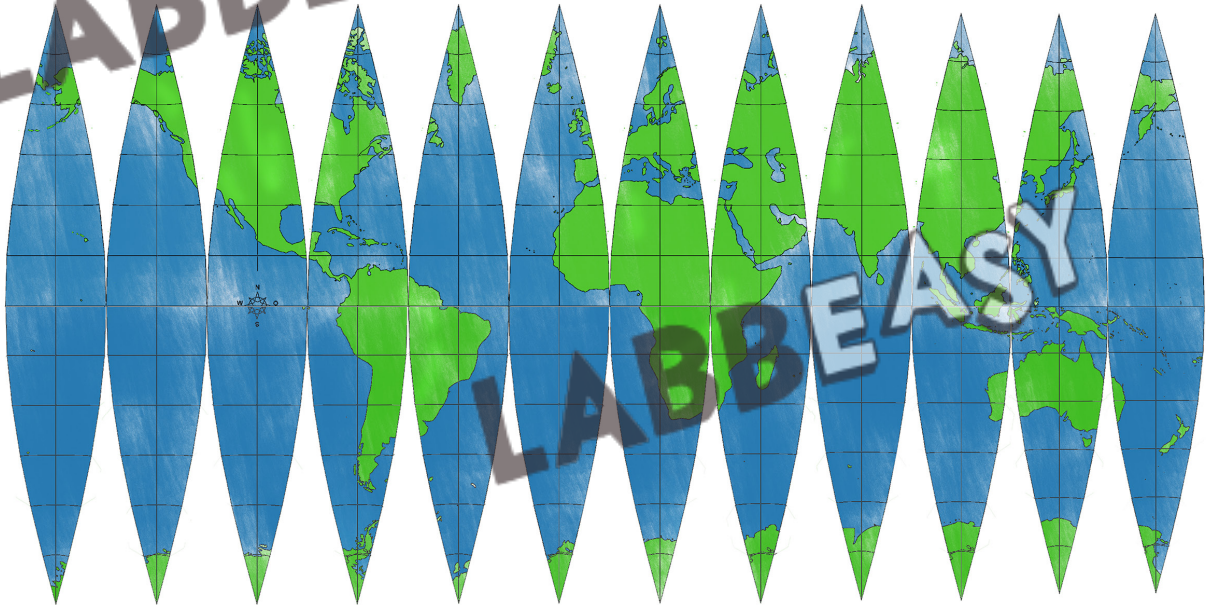

GLOBE SEGMENTS

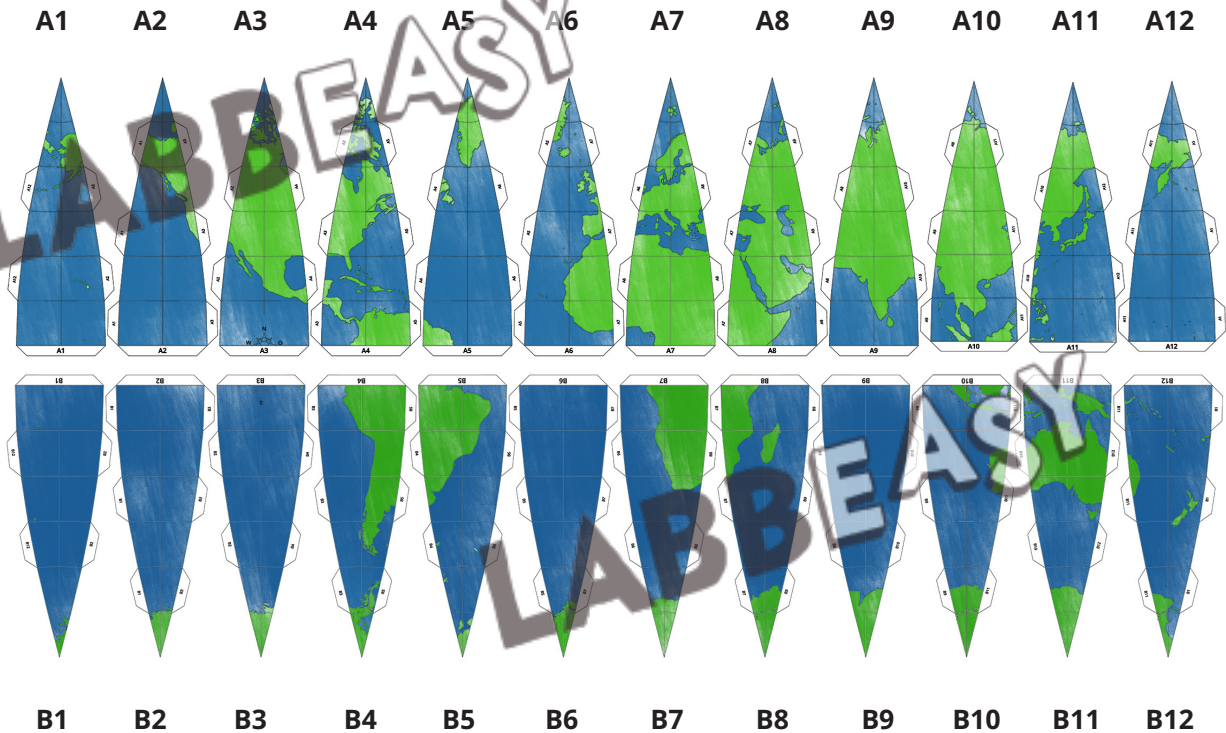

Large Paper Globe

Support elements

Print x 11

